

## ISO 2341B Celvis Pin With Cross Drilled Hole

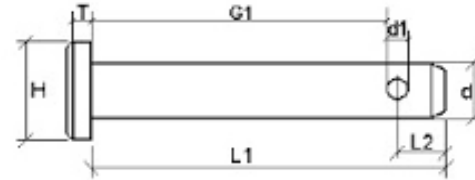

ISO 2341B Clevis Pin With Cross Drilled Hole						
Nominal Diameter-d	5	6	8	10	12	14
Diameter Tolerance	h11					
Head Diameter - H	8	10	14	18	20	22
Hole Diameter - d1	1.6	1.6	2	3.2	3.2	4
Head Thickness - T	1.6	2	3	4	4	4
Lengths - L1	10 To 50	12 To 60	16 To 80	20 To 100	24 To 120	28 To 140
Length - L2 Minimum	2.9	3.2	3.5	4.5	5.5	6
Length - G1	SEE PIN DRAWING REQUEST PAGE					
Length Tolerances	Up to 10m/m L/g + / - 0.25		12 - 50m/m L/g + / - 0.50		Over 50m/m L/g + / - 0.75	

Material	
<i>Mild Steel</i>	<i>Zinc Plated</i>
<i>Stainless Steel</i>	<i>A2</i>
<i>Stainless Steel</i>	<i>A4</i>

INFORMATION AND DRAWINGS PROVIDED ARE FOR REFERENCE ONLY